

Installation information for QUICKPANEL, QUICKPANEL jr., and QUICKPANEL mini

NOTICE: The panel clamps are packed in the carton.

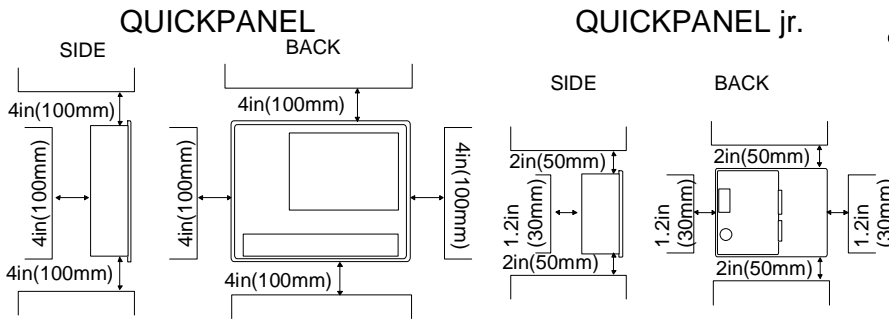

- For easier maintenance and proper ventilation, ensure the display is mounted away from surrounding objects.

Precautions

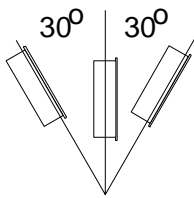

- When installing the display on a slanted panel, the slope of the panel should be within 30 degrees from the vertical position. If the slope is greater than 30 degrees, provide fan cooling.
- Ensure heat from other equipment does not interfere with the display.
- For proper ventilation, provide 4" of clearance around the QUICKPANEL and 2" of clearance around the QUICKPANEL jr.
- Ground the display to earth ground.
- Panel thickness = (1.6mm~10mm) .063in~.394in for QUICKPANEL (1.6mm~5mm) .063in~.197in for QUICKPANEL jr.

- Install the gasket in the slot in the faceplate.

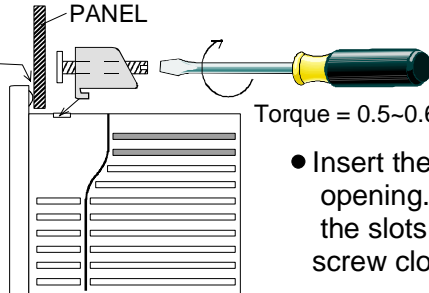
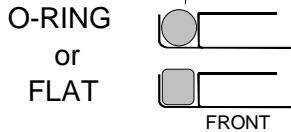

Torque = 0.5-0.6Nm

- Insert the display through the panel opening. Insert the panel clamps into the slots in the display body. Turn screw clockwise to tighten.

Units Marked UL and c-UL

Use No. 14 to 18 AWG, solid or stranded copper conductors and note the following precautions. Suitable for use in Class I, Division 2, Groups A, B, C and D hazardous locations, or nonhazardous locations only. Power, Input and Output (I/O) wiring must be in accordance with Class I, Division 2 wiring methods, Article 501-4(b) of the National Electrical Code, NFPA 70 or as specified in Section 18-152 of the Canadian Electrical Code for installations within Canada and in accordance with the authority having jurisdiction.

- WARNING:** Explosion hazard - substitution of components may impair suitability for Class I, Division 2.
- WARNING:** Explosion hazard - do not disconnect equipment unless power has been switched off or the area is known to be nonhazardous.
- WARNING:** Explosion hazard - when in hazardous locations, turn off power before replacing or wiring modules.

AC Power



MAKE SURE THE POWER IS OFF

- Remove the protective cover on the AC terminal strip. Remove 1/4" of insulation from the supply wires and insert them under the terminal clamps. Tighten the clamp screws to secure the wires. Replace the protective cover.

DC Power

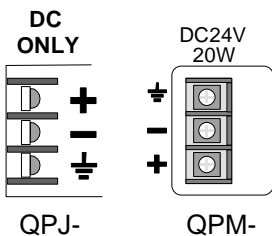

MAKE SURE THE POWER IS OFF

- Remove the protective cover on the DC terminal strip. Remove 1/4" of insulation from the supply wires and insert them under the terminal clamps. Tighten the clamp screws to secure the wires. Replace the protective cover.

QUICKPANEL 12.1" (QPL-xxxxx-C2P), 10.5" (QPI-xxxxx-xxx) & 9" (QPI-xxxxx-Exx)

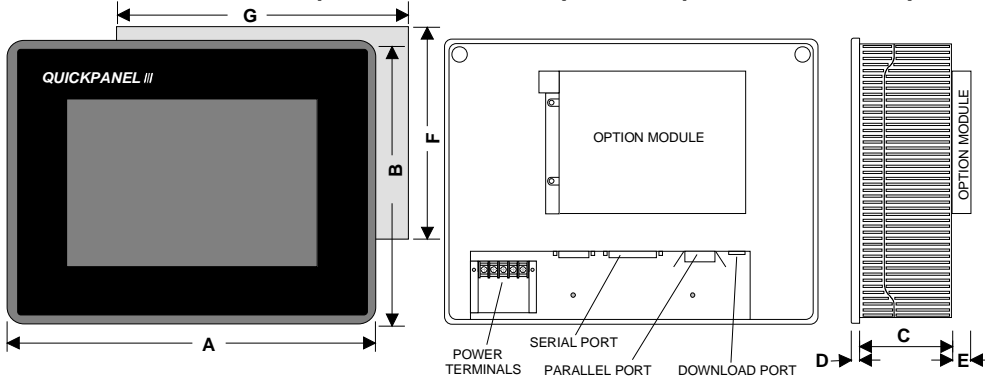

- Option modules
- QPI-ABD-201 A-B DH Plus
 - QPI-ABR-201 A-B Remote I/O
 - QPI-MBP-201 Modbus Plus
 - QPI-GEG-201 GE Genius
 - QPI-DVN-202 DeviceNet
 - QPI-IBS-201 Interbus-S
 - QPI-PBS-201 Profibus
 - QPI-COS-201 CANopen

Model	Dim A	Dim B	Dim C	Dim D	Dim E	Dim F	Dim G
QPI-xxxxx-Sxx QPI-xxxxx-Cxx QPI-xxxxx-Lxx	12.480(317mm)	9.570(243mm)	3.05(77.5mm)	.3(7.5mm)	1.25(32mm)	8.98(228+/-0.5mm)	11.89(302+/-0.5mm)
QPI-xxxxx-Exx	10.79(274mm)	8.5(216mm)	1.93(49mm)	.3(7.5mm)	1.25(32mm)	7.92(201+/-1mm)	10.20(259+/-1mm)
QPL-xxxxx-C2P	13.62(346mm)	10.70(272mm)	2.90(73.5mm)	.3(7.5mm)	1.25(32mm)	10.16(258+/-1mm)	13.07(332+/-1mm)
QPI-xxxVx-Cxx (Video)	12.480(317mm)	9.570(243mm)	3.05(77.5mm)	.3(7.5mm)	1.25(32mm)	8.98(228+/-0.5mm)	11.89(302+/-0.5mm)

QUICKPANEL jr. 5" Displays (QPJ-xxxxx-xxx), 6" Displays (QPK-xxxxx-xxx), QUICKPANEL mini 6" Display (QPM-2xxxx-L2P or QPM-3xxxx-B2P)

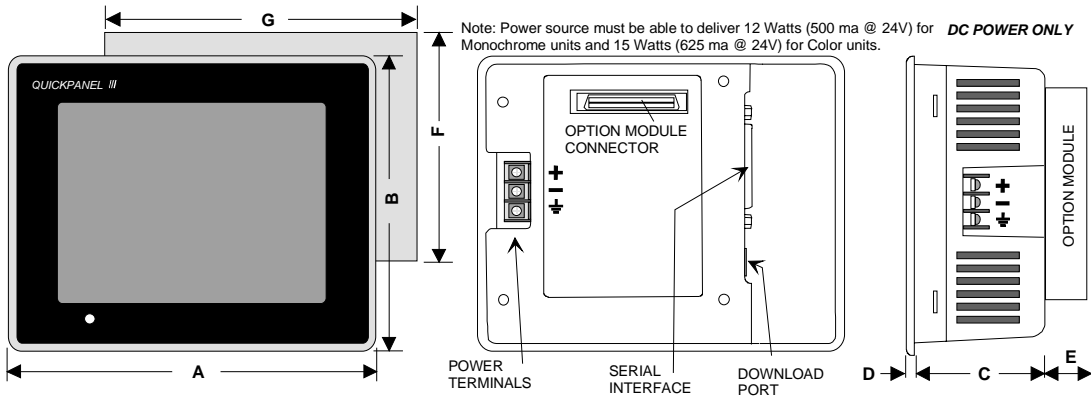

- Option modules
- QPJ-ABD-201 A-B DH Plus
 - QPJ-ABR-201 A-B Remote I/O
 - QPJ-MBP-201 Modbus Plus
 - QPJ-GEG-201 GE Genius
 - QPJ-DVN-202 DeviceNet
 - QPJ-IBS-201 Interbus-S
 - QPJ-PBS-201 Profibus
 - QPJ-COS-201 CANopen

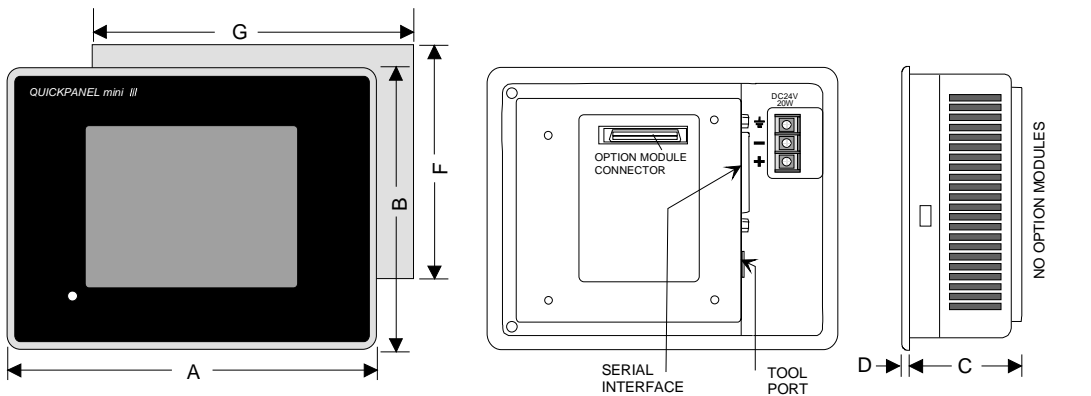

Note: Option modules are not supported on QPM-xDx00-x2P)

NOTE the location and polarity markings on the 24VDC terminal strip for the QPM.

Model	Dim A	Dim B	Dim C	Dim D	Dim E	Dim F	Dim G
QPJ-xxxxx-xxx	6.75(172mm)	5.00(127mm)	2.125(54mm)	.197(5mm)	1(25mm)	4.45(113+/-0.5mm)	6.22(158+/-0.5mm)
QPK-xxxxx-xxx	6.71(170.5mm)	5.43(138mm)	2.24(57mm)	.197(5mm)	1(25mm)	4.86(123.5+/-0.5mm)	6.10(155+/-0.5mm)
QPM-2xxxx-L2P	8.267"(210mm)	6.30"(160mm)	2.28"(58mm)	.197"(5mm)	N/A	5.59"(142mm)	7.56"(192mm)
QPM-3xxxx-B2P	8.15" (207mm)	6.18" (157mm)	2.04" (52mm)	.24" (6mm)	N/A	5.57" (141.5mm)	7.54" (191.5mm)